

Layout Tab Name: C200, Images: ., Xrefs: 81172-p.dwg; 81172-x.dwg; 81172TLK.dwg
 Last Saved By: Cederquist, 8/3/2020 3:11:54 PM
 G:\DE\clients\Fisher Construction Group\081172 Brownsburg Project Aisle Facility\4.0 Disciplines\Civil\Cadd\Cd\81172DEV.dwg Plotted By: Cederquist, Brooke Plotted: August 3, 2020, 4:23:16 PM

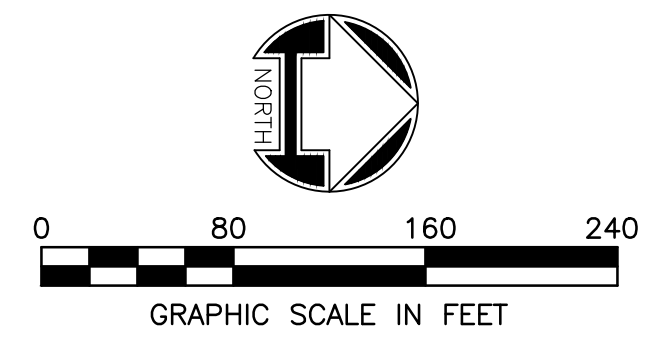
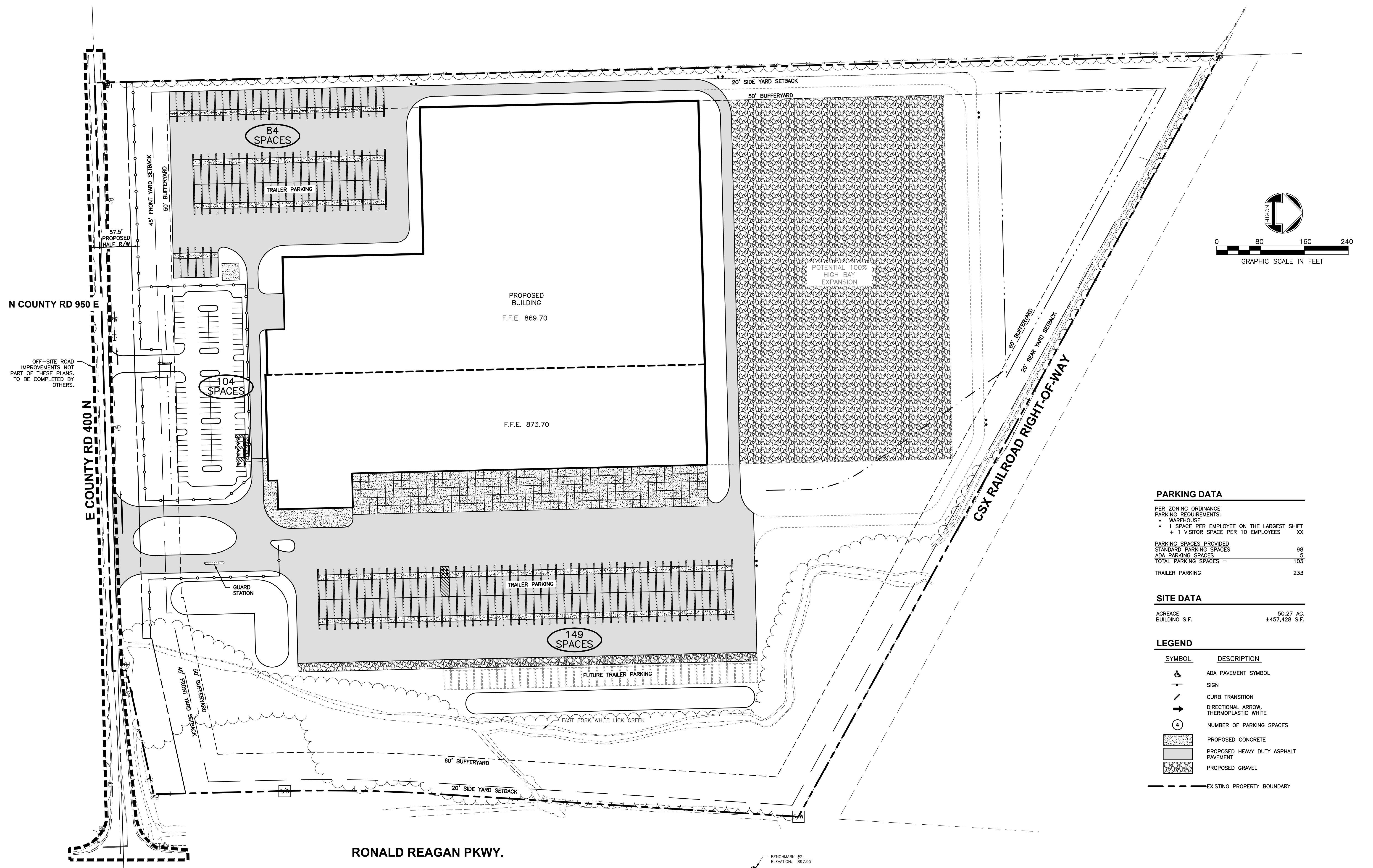

PARKING DATA

PER ZONING ORDINANCE
 PARKING REQUIREMENTS:

- WAREHOUSE
- 1 SPACE PER EMPLOYEE ON THE LARGEST SHIFT
- + 1 VISITOR SPACE PER 10 EMPLOYEES XX

PARKING SPACES PROVIDED

STANDARD PARKING SPACES	98
ADA PARKING SPACES	5
TOTAL PARKING SPACES =	103
TRAILER PARKING	233

SITE DATA

ACREAGE	50.27 AC.
BUILDING S.F.	±457,428 S.F.

LEGEND

SYMBOL	DESCRIPTION
	ADA PAVEMENT SYMBOL
	SIGN
	CURB TRANSITION
	DIRECTIONAL ARROW, THERMOPLASTIC WHITE
	NUMBER OF PARKING SPACES
	PROPOSED CONCRETE
	PROPOSED HEAVY DUTY ASPHALT PAVEMENT
	PROPOSED GRAVEL
	EXISTING PROPERTY BOUNDARY

REVISION	No.	DATE

PROJECT No: 81172
 DATE: 08/03/20
 DES. DR. CKD.

333 North Alabama Street
 Suite 200
 Indianapolis, IN 46204
 317.299.7500
 FAX: 317.291.5805

WOOLPERT
 ARCHITECTURAL ENGINEERING (CORPORATE)

PROJECT AISLE

EAST C.R. 400N AND RONALD REAGAN PKWY.
 BROWNSBURG, INDIANA

OVERALL SITE PLAN

SHEET NO.
C200

